

- NOTES:
1. ALL DRAWINGS TO BE CHECKED BY CONTRACTOR ON SITE AND ENGINEER INFORMED OF DISCREPANCIES BEFORE WORK COMMENCES.
 2. THE CONTRACTOR SHALL SAFETY HAUL AS TO THE ACCORDANCE OF EXISTING SIGNAGE LEVELS AND LOCATION OF EXISTING SERVICES ON SITE PRIOR TO COMMENCEMENT OF WORKS ON SITE. ALL SERVICES ARE IN METERS AND ARE RELATED TO ORDNANCE DATUM. CO-ORDINATES RELATE TO IRISH NATIONAL GRID.
 3. ALL WATERMAIN VALVES AND FITTINGS SHALL BE CONTROLLED IN ACCORDANCE WITH THE IRISH WATER STANDARD DETAILS AND IRISH WATER CODE OF PRACTICE FOR WATER MAINS/RESERVE.
 4. ALL WATERMANS SHALL BE HOPE, PE100, SDR17 TO IS EN 12201 - PART 2/2011 AND IS EN 12201-3/2011.
 5. CONNECTION BETWEEN EXISTING AND PROPOSED WATERMANS TO BE CARRIED OUT IN ACCORDANCE WITH IRISH WATER STANDARD DETAILS STD-W-03 TO STD-W-10.
 6. ANCHOR BLOCKS TO BE POSITIONED AT EACH END, TEES, BENDS AND AT EACH SIZE OF HYDRANTS AND VALVES IN ACCORDANCE WITH THE REQUIREMENTS OF IRISH WATER STANDARD DETAILS STD-W-28 (WATER MAIN THROUST AND SUPPORT BLOCKS/ANCHORING JOINTS TO BE INSTALLED AT EACH SLUDGE VALVE AS PER IRISH WATER STANDARD DETAIL STD-W-28).
 7. CONNECTION TO REVERVAL HOUSES IN ACCORDANCE WITH IRISH WATER STD-W-03.
 8. INSTALLATION OF SLUDGE VALVES, AIR VALVES AND HYDRANTS SHALL BE IN ACCORDANCE WITH IRISH WATER STANDARD DETAILS STD-W-11 TO STD-W-25.
 9. MARKER POSTS AND PLATES ARE TO BE PROVIDED IN ACCORDANCE WITH IRISH WATER STANDARD DETAIL STD-W-27.
 10. CONNECTION TO EXISTING WATERMANS TO BE CO-ORDINATED BY THE CONTRACTOR WITH IRISH WATER AND/OR THE LOCAL AUTHORITY.
 11. CONTRACTOR TO LIAISE WITH IRISH WATER AND / OR THE LOCAL AUTHORITY AS REQUIRED REGARDING TESTING, CLEARING AND DISINFECTION OF WATERMANS.
 12. WATERMANS TO BE PRESSURE TESTED IN ACCORDANCE WITH THE REQUIREMENTS OF IRISH WATER AND IS EN 12201-3/2011. GUIDE TO TESTING OF PRESSURE PIPES AND FITTINGS FOR USE OF PUBLIC WATER SUPPLIES, OCTOBER 2003. A FORMAL TEST REPORT SHALL BE SUBMITTED TO THE ENGINEER DETAILING THE TEST CARRIED OUT.
 13. METERS FOR APARTMENTS OR SIMILAR PROPERTIES WILL BE INSTALLED BY IRISH WATER IN ACCORDANCE WITH THE BUILDING CONTROL AUTHORITY REQUIREMENTS AND SUBJECT TO REVIEW BY IRISH WATER.

- LEGEND:
- SITE BOUNDARY
 - PROPOSED ROAD
 - PROPOSED FOOTPATH
 - PROPOSED BUILDING
 - PROPOSED CYCLE PATH
 - PROPOSED SHARED PATH
 - PROPOSED VERGE
 - PROPOSED PERMEABLE PAVING
 - PROPOSED ROAD GRADIENT
 - PROPOSED ROAD LEVELS
 - EXISTING 200MM DUCTILE IRON WATERMAIN
 - PROPOSED 200MM (INTERNAL DIAMETER) WATERMAIN
 - PROPOSED 150MM (INTERNAL DIAMETER) WATERMAIN
 - SLUDGE VALVES TO IRISH WATER STANDARD DETAIL STD-W-14/15
 - SCOUR VALVES TO IRISH WATER STANDARD DETAIL STD-W-30/35A/30B
 - HYDRANTS TO IRISH WATER STANDARD DETAIL STD-W-11/18
 - METER CHAMBER TO IRISH WATER STANDARD STD-W-26
 - METER CHAMBER TO IRISH WATER STANDARD STD-W-26C
 - TELEMETRY HOUSING (AS PER IRISH WATER STD-W-36)
 - AIR VALVE TO IRISH WATER STANDARD DETAIL STD-W-20/22
 - IRISH WATER SERVICE CONNECTION WITH BOUNDARY BOX TO IRISH WATER STANDARD STD-W-03
 - EXISTING STREAM: HAZELWATH WATERCOURSE (EAST)
 - SHANADEA STREAM (WEST)

POS	09-06-22	PLANNING SUBMISSION	DNE	NOI
PM	25-05-22	SODA Comments Amendment 24/05/22	PLY	NOI
POS	14-05-22	SODA Comments Amendment	PLY	NOI
POS	14-04-22	For SODA	PLY	NOI
POS	04-11-21	ISSUED FOR PLANNING	PLY	NOI
POS	01-08-21	REVISION	SY	2962

client approval	A - Approved
	B - Approved with comments
	C - Do not use
stage approval	PLANNING

DBFL	DBFL Consulting Engineers
100/100	100/100
100/100	100/100

PROJECT: BALLYOULSTER KDA SHD - PHASE 1 RESIDENTIAL DEVELOPMENT

DRAWING TITLE: WATERMAIN LAYOUT SHEET 1

CLIENT: KIERAN CURTIN, RECEIVER OVER CERTAIN ASSETS OF MAPLEWOOD DEVELOPMENTS UNLIMITED COMPANY

DATE: 09-06-22

SCALE: 1:500

PROJECT NO: 180221-DBFL-WM-SP-DR-C-1041

DATE: 09-06-22

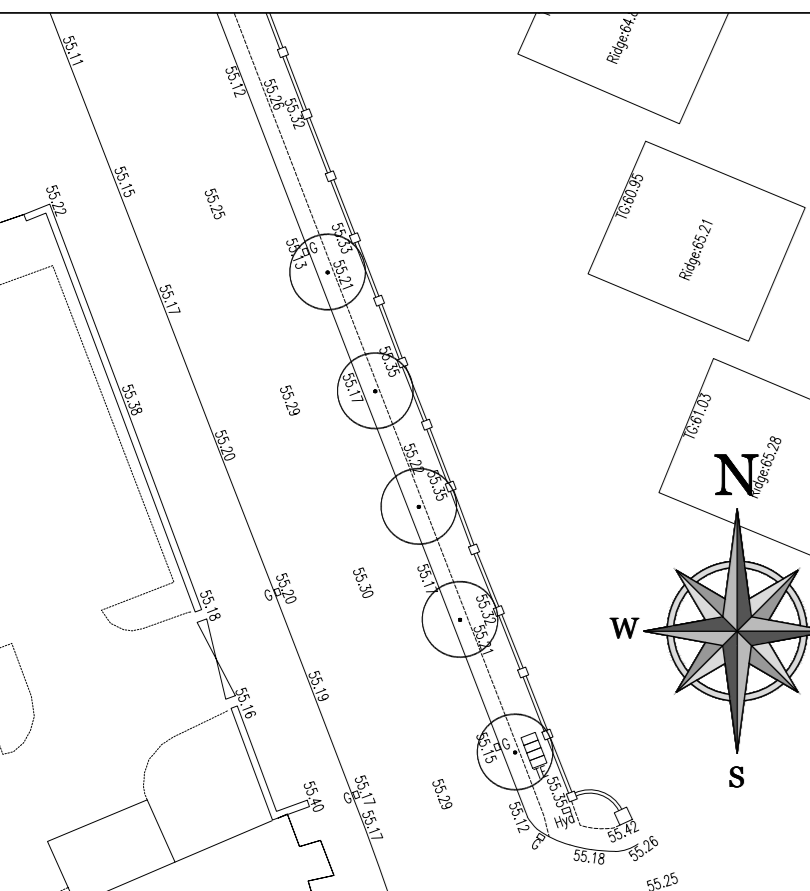
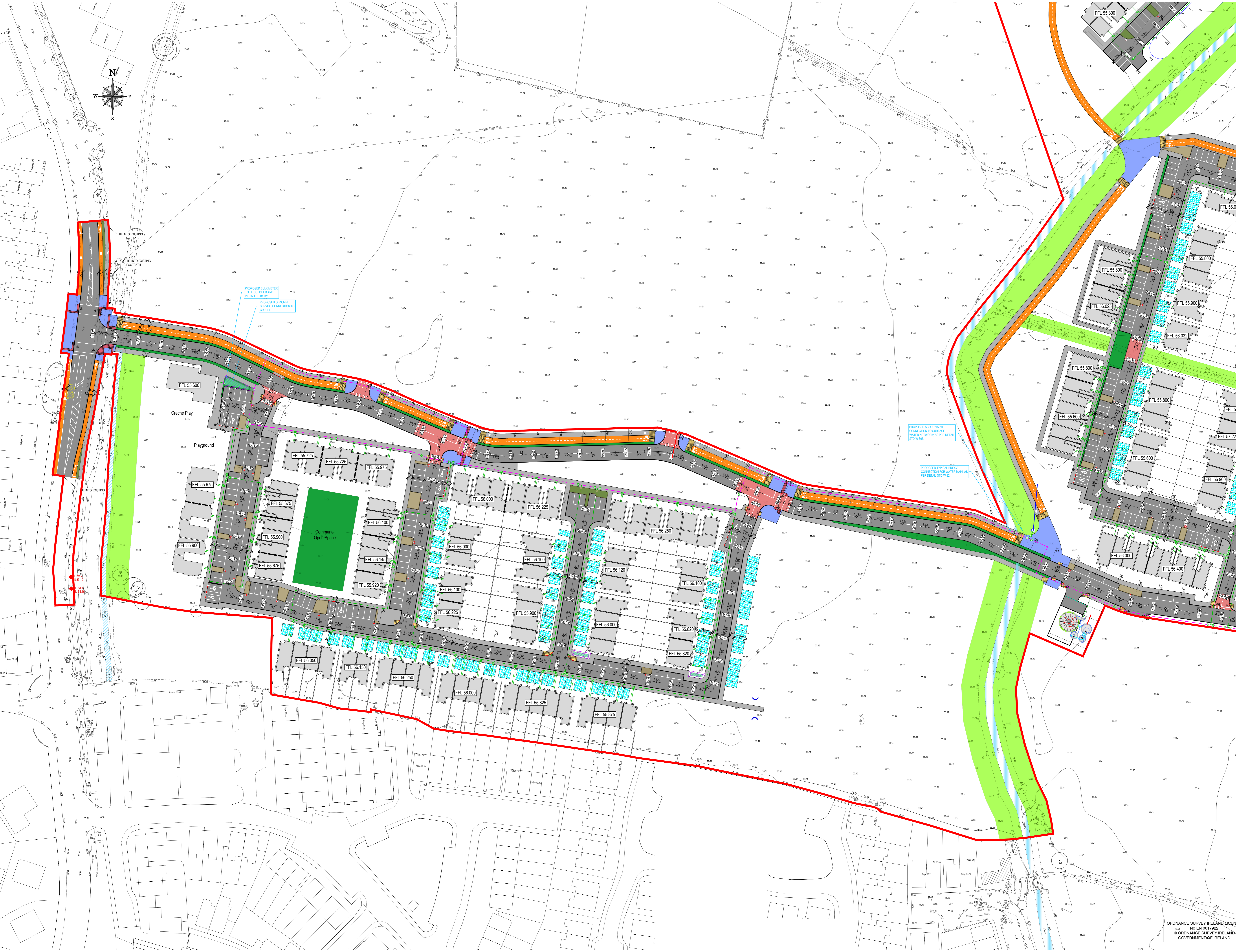

ORDNANCE SURVEY IRELAND LICENCE
No. EN 0017922
© ORDNANCE SURVEY IRELAND
GOVERNMENT OF IRELAND